

Pre-assembled to make installation easier

## GTW profiles for glass thicknesses of between 8 and 17.52 mm



### Pre-assembled clamping profile comprising:

- Aluminium base frame
- 2 aluminium stainless steel effect cover profiles
- Optionally untreated for powder coating on-site
- Clamping screws

### Special features compared to standard profiles on the market:

- Continuous profile of up to 6,000 mm in one piece
- Continuous rubber inserts on both sides

### Profiles for the following glass thicknesses :

- GTW-8 for 8 mm TSG and 8.76 mm LSG
- GTW-10 for 10 mm TSG and 10.76 mm LSG
- GTW-12 for 12 mm TSG and 12.76 mm LSG
- GTW-1752 for 17.52 mm LSG

Individual length of 250 mm to 6,000 mm

Stainless steel effect end caps for easy clipping

## For integral glass walls

### Technology :

- Height: 42 mm/Width: 33 mm
- Clearance of glass: 19 mm
- Wall fastening: Drilled holes spaced at 400 mm
- Clamping profile: Hole spacing 200 mm
- Rubber inserts are on the inside on both sides of the profile as continuous strands

### Sample applications with glass :

- Office partitions
- Stairwell partitions
- Shower partitions
- Exhibition stand construction
- Air-conditioned rooms
- Hygiene room partitions
- Mechanical engineering: Safety partitions
- Acoustic engineering
- Saunas
- Steam showers
- and many other things too

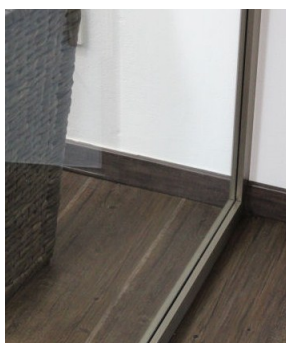

## For TSG or LSG

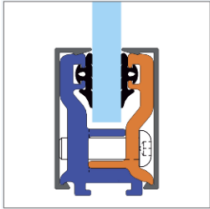
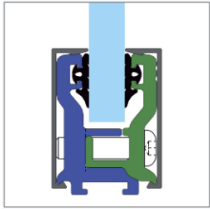
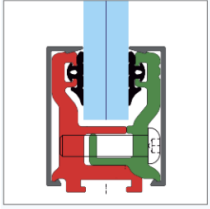
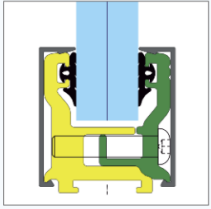
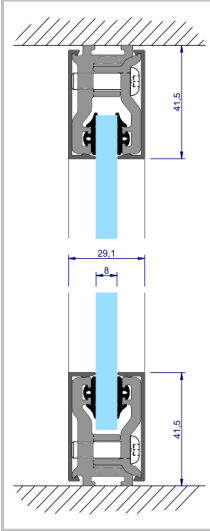
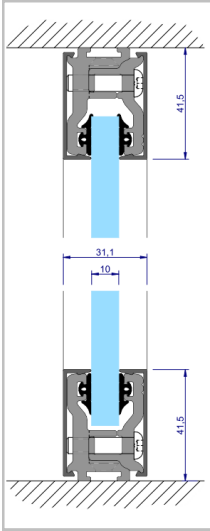
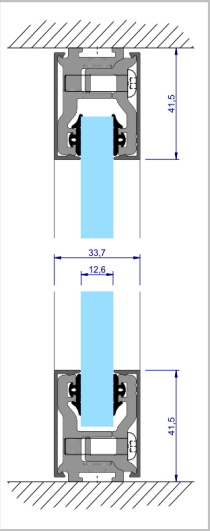
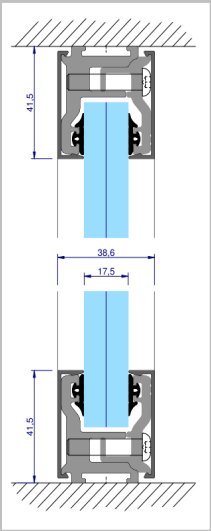
GTW-8	GTW-10	GTW-12	GTW-1752
For eight - 8.76 mm glass	for 10 - 10.76 mm glass	for 12 - 12.76 mm glass	for 17,52 mm glass
			
			
Article No. GTW-8	Article No . GTW-10	Article No . GTW-12	Article No . GTW-1752



# Door frames & door hardware

For glass thicknesses of 8 and 10 mm

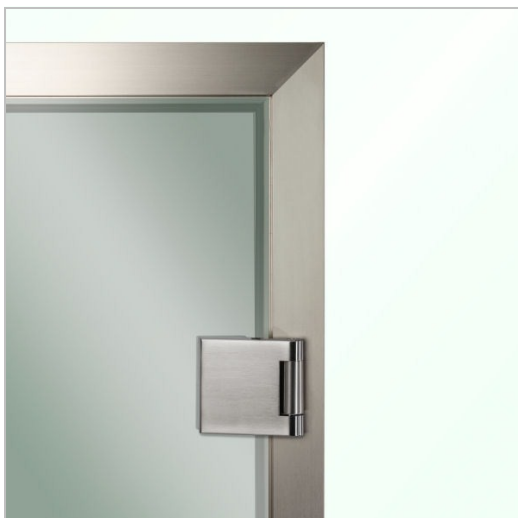

The GTWZ door frame is identical in appearance to the GTW clamping profile. GTW frames are pre-assembled and are supplied as two door jambs for the right-hand and left-hand sides plus a lintel. You carry out assembly on-site by simply screwing together the two inner brackets that are designed to connect the lintel and the jambs.

An additional continuous rubber profile ensures that the door closes quietly.

**Article No.**

**GTWZ plus indication of DIN dimension plus indication of hinged right/left. For more information, see our Web page .**

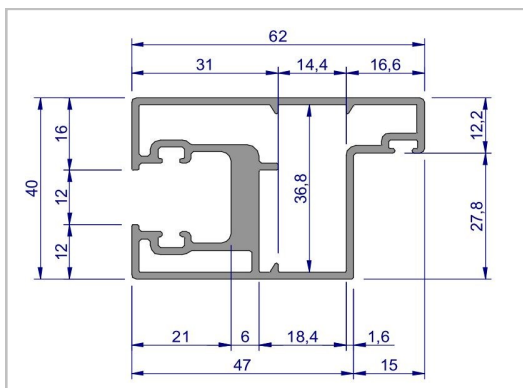

## Advantages of GTWZ door frames

- Dimensions according to DIN 18101 or custom dimensions
- Suitable supports for standard steel glass hinge plates
- Identical in appearance to GTW clamping profiles
- for glass thicknesses of 8 and 10 mm
- optionally includes hinge plates, door lock, pair of handles and profile cylinder

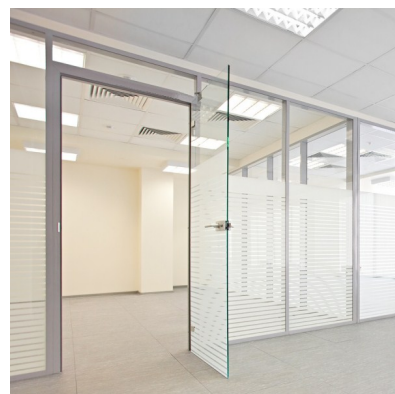

## Dimensions of Office and Studio type doors according to DIN 18101

	(all stated in mm )					
Approximate carcass dimensions	750 x 2.000	875 x 2.000	1.000 x 2.000	750 x 2.125	875 x 2.125	1.000 x 2.125
Frame rebate dimension	716 x 1.983	841 x 1.983	966 x 1.983	716 x 2.108	841 x 2.108	966 x 2.108
Standard glass dimension	709 x 1.972	834 x 1.972	959 x 1.972	709 x 2.097	834 x 2.097	959 x 2.097
Min. wall opening size	772 x 2.011	896 x 2.011	1.022 x 2.011	772 x 2.136	896 x 2.136	1.022 x 2.136
Max. Wall opening size	784 x 2.017	908 x 2.017	1.034 x 2.017	784 x 2.142	908 x 2.142	1.034 x 2.142
External dimension of frame	810 x 2.030	935 x 2.030	1.060 x 2.030	810 x 2.155	935 x 2.155	1.060 x 2.155

### DIN left hinge and DIN right hinge

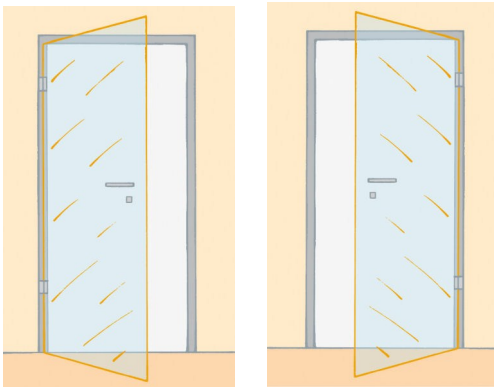

The direction of opening for room doors is defined as follows:

In the case of "DIN left", the hinge plates are on the left-hand side and the door opens inwards. In the case of "DIN right", the hinge plates are on the right-hand side and the door opens inwards.

In this connection, "inside" is the side of the door on which you can see the hinges. In the case of shower doors, the view is from

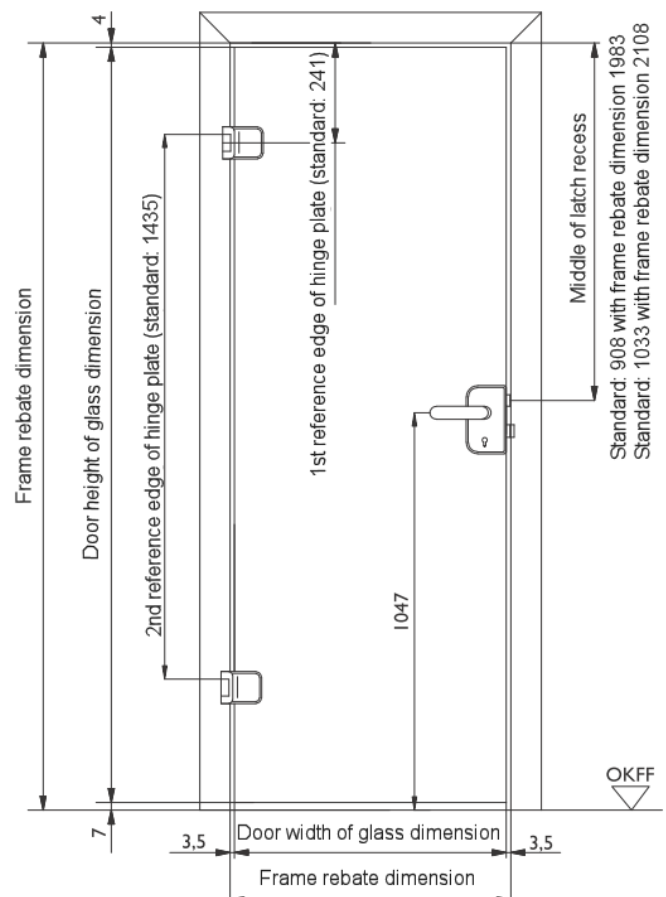

### Important information

Our door frames are available either in dimensions as per DIN 18101 or in custom dimensions. In this connection, the important thing is whether the dimension in question refers to the glass or the door frame. The door frame dimension is 7 mm wider than the glass dimension.

## Stainless steel hinge plates and door lock



### Rectangular hinge plate set including fastening material

- Two hinge plates made of solid stainless steel
- Surface brushed matte
- Two supports for steel frames
- Load capacity per pair of 55 kg
- For max. door width of 1,000 mm
- Drilled glass hole D=16 mm/18 mm (for additional adjustment options)

**Article No.**  
**GTWT-6325**



### Square Studio door lock including handle set

- Studio door lock with stainless steel cover
- Surface brushed matte
- Pair of handles, square design, stainless steel
- Optionally without locking mechanism or with profile cylinder hole
- For left or right door hinge

**Article No.**  
**GTWT-6081 plus information about hole**



### Square Office door lock including handle set

- Office door lock with stainless steel cover
- Surface brushed matte
- Pair of handles, square design, stainless steel
- Optionally without locking mechanism or with profile cylinder hole
- For left or right door hinge

**Article No.**  
**GTWT-6051 plus information about hole and hinged right/left**



### Profile cylinder suitable for GTWT door lock

- Cylinder including three keys

**Article No.**  
**GTWT-6892**



## Profiles made of stainless steel effect aluminium



### Aluminium H profile

- 180° connecting profile
- For glass thicknesses of 8 | 10 | 17.52 mm
- Internal dimension: 9 | 11 | 18 mm
- Length up to 6,000 mm

#### Article No.

GTW-ECO-H8

GTW-ECO-H10

GTW-ECO-H1752

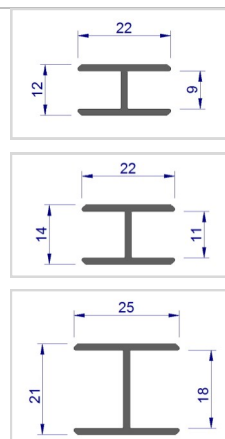

### Aluminium U profile

- U shape
- For glass thicknesses of 8 and 10 mm
- Internal dimension: 9 | 11 mm
- Length up to 6,000 mm

#### Article No.

GTW-ECO-U8

GTW-ECO-U10

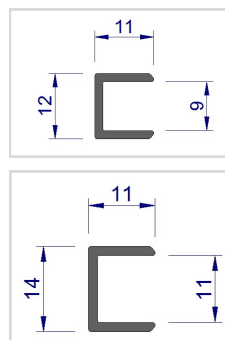

### Aluminium E profile

- Corner profile
- For glass thicknesses of 8 and 10 mm
- Internal dimension: 9 | 11 mm
- Length up to 6,000 mm

#### Article No.

GTW-ECO-E8

GTW-ECO-E10

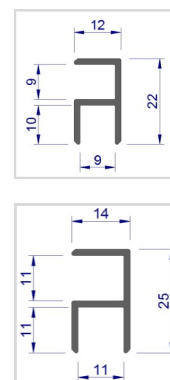

## Baseboard

made of stainless steel effect aluminium



The bottom rail is identical in appearance to the glass partition profiles and the door frame.

- External dimension: 40 x 11 mm
- Cable duct with polyamide holders to route through up to four cables
- Length: 6,000 mm
- Possible to shorten to optimise shipping

**Article No.**  
**GTWS-6000**



**ETG GmbH** | Brinkeweg 7 | D-33758 Schloss Holte-Stukenbrock  
Telefon: +49 (0) 52 07 - 95 75 70 | Telefax: +49 (0) 52 07 - 95 75 713  
[info@edelstahl-trifft-glas.de](mailto:info@edelstahl-trifft-glas.de) | [www.edelstahl-trifft-glas.de](http://www.edelstahl-trifft-glas.de)